

- NOTES:**
- DO NOT SCALE OFF THIS DRAWING. ALWAYS WORK TO NOTED DIMENSIONS.
 - ALL DIMENSIONS MUST BE VERIFIED ON SITE BEFORE COMMENCING WORK. DISCREPANCIES MUST BE REPORTED TO THE ENGINEER.
 - THIS DRAWING IS TO BE READ IN CONJUNCTION WITH ALL OTHER DISCIPLINE'S DRAWINGS, REPORTS AND SPECIFICATIONS.
 - REFER TO ARCHITECT'S DRAWINGS FOR ALL SITE & APPLICATION REQUIREMENTS.
 - REFER TO SURVEY DRAWINGS FOR EXISTING SERVICES LAYOUTS AND MINIMUM INFORMATION FOR CONSTRUCTION OF NEW SERVICES.
 - THE CONTRACTOR SHALL VERIFY ALL DIMENSIONS AND LEVELS WITH ARCHITECTURAL DRAWINGS PRIOR TO START OF CONSTRUCTION. ANY DISCREPANCIES TO BE NOTIFIED TO THE ENGINEER & ARCHITECT FOR RESOLUTION.
 - CONTRACTOR TO ENSURE ALL WATER & WASTEWATER RELATED WORKING ARE IN ACCORDANCE WITH THE RISH WATER WATER INFRASTRUCTURE CODE OF PRACTICE & STANDARD DETAIL DOCUMENTS.
 - TESTING OF ALL GRAVITY SERVICES AND MANHOLES TO BE IN ACCORDANCE WITH RISH WATER CODE OF PRACTICE FOR WASTEWATER INFRASTRUCTURE SECTION 4.1 TESTING OF GRAVITY SERVICES & MANHOLES.

NOTE!
REFER TO DOBA DRG C-0200 FOR PROPOSED SURFACE WATER DRAINAGE LAYOUT
REFER TO DOBA DRG C-0300 FOR PROPOSED FOUL WATER DRAINAGE LAYOUT

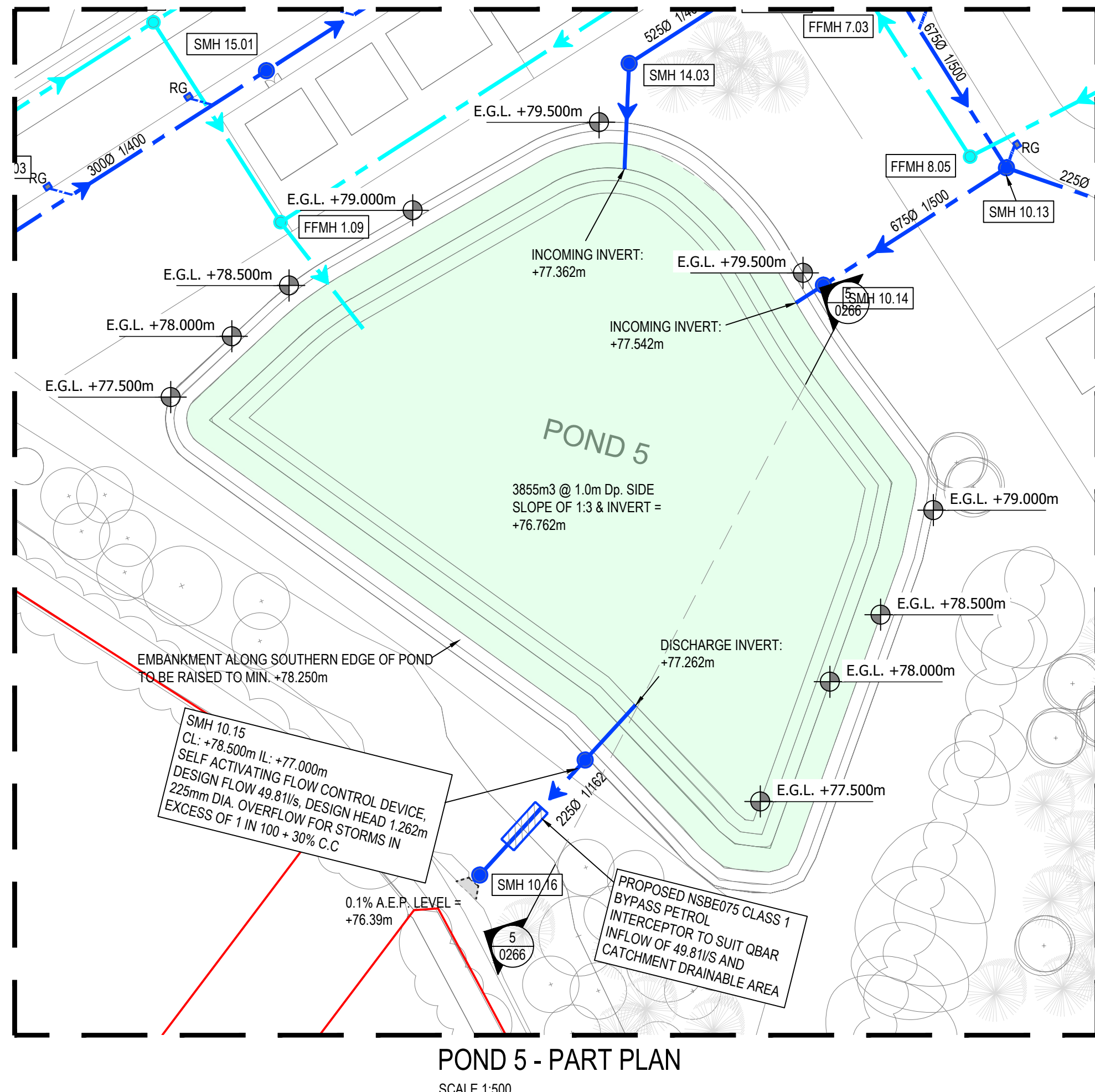
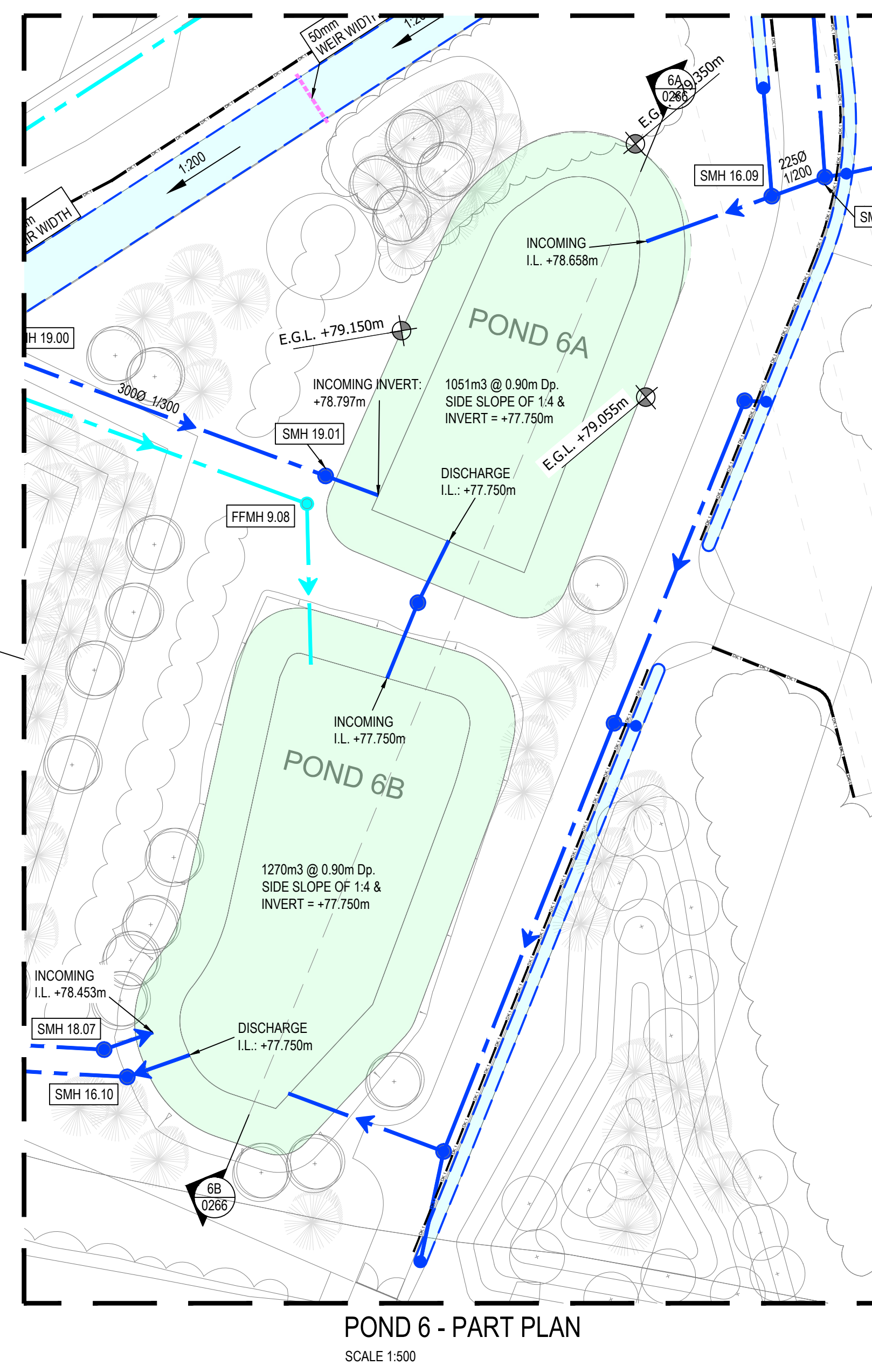
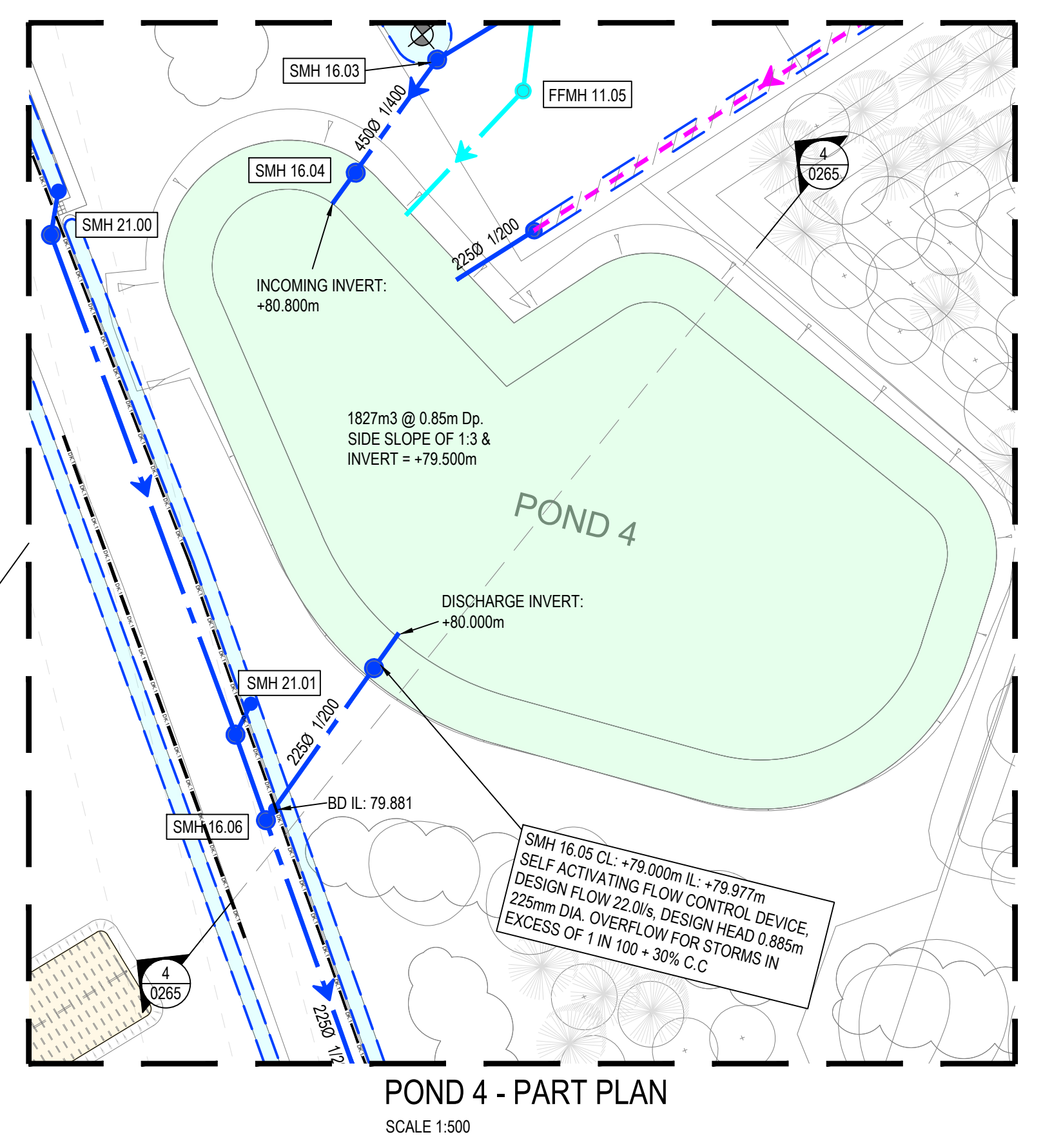
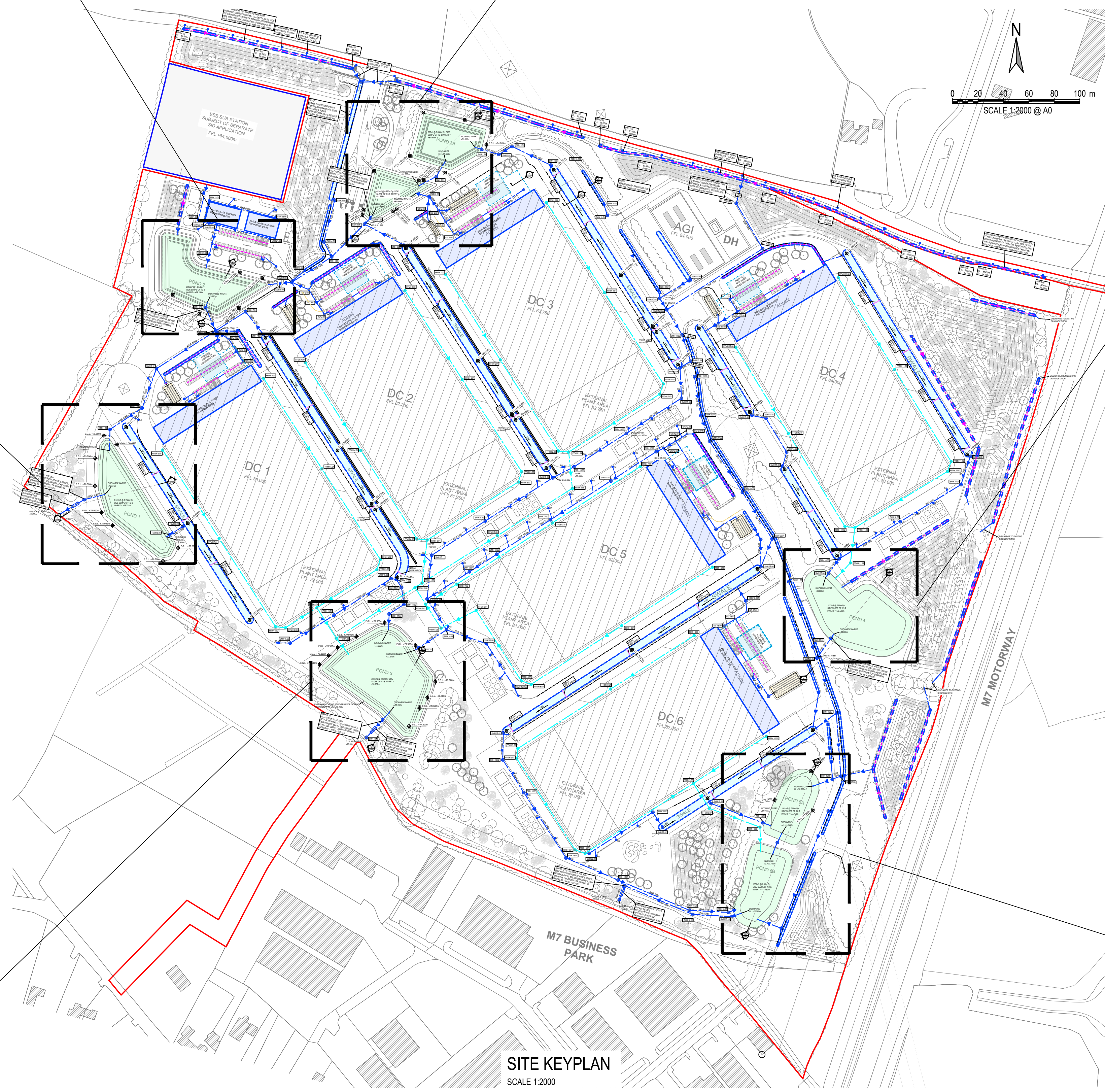
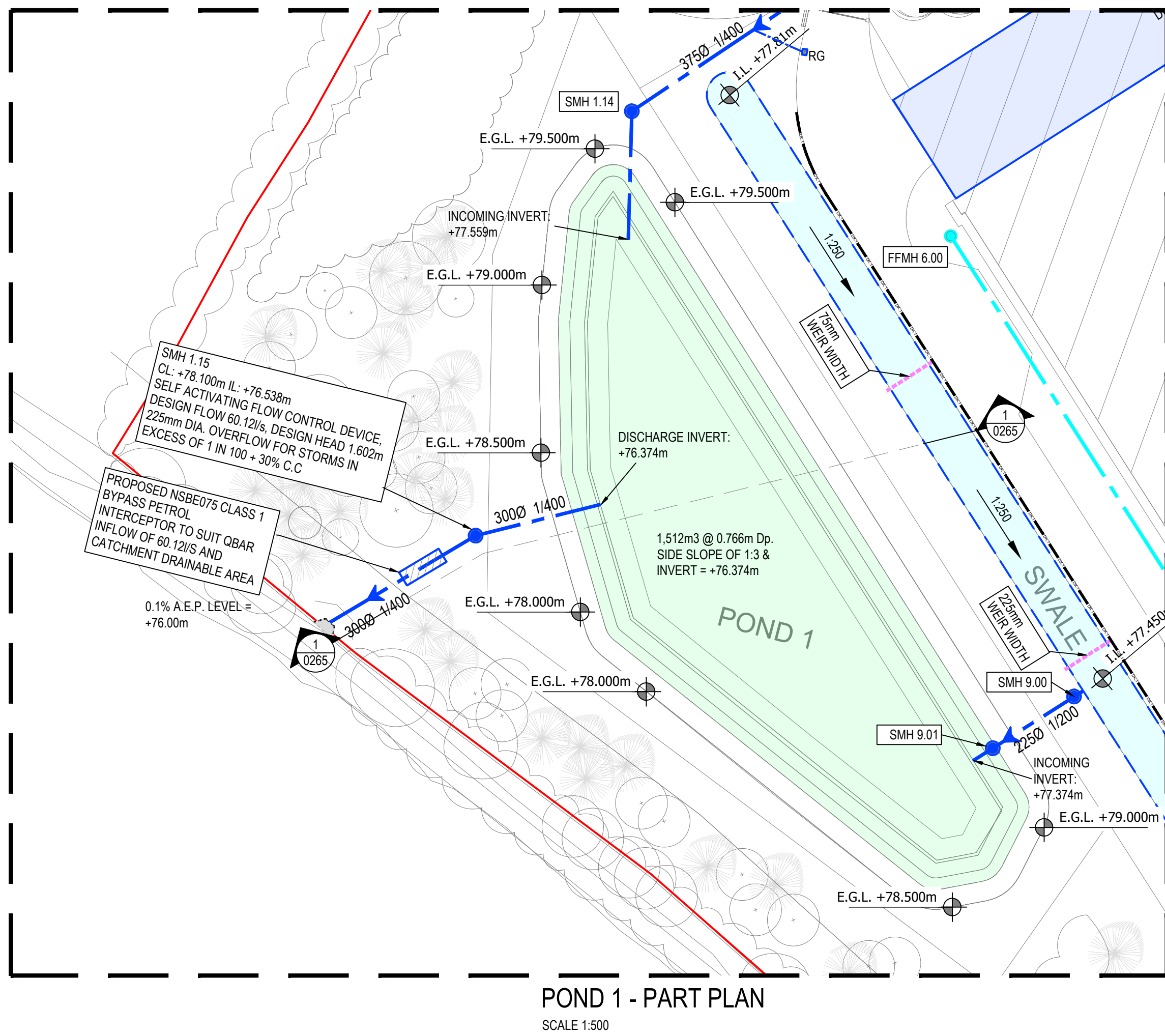
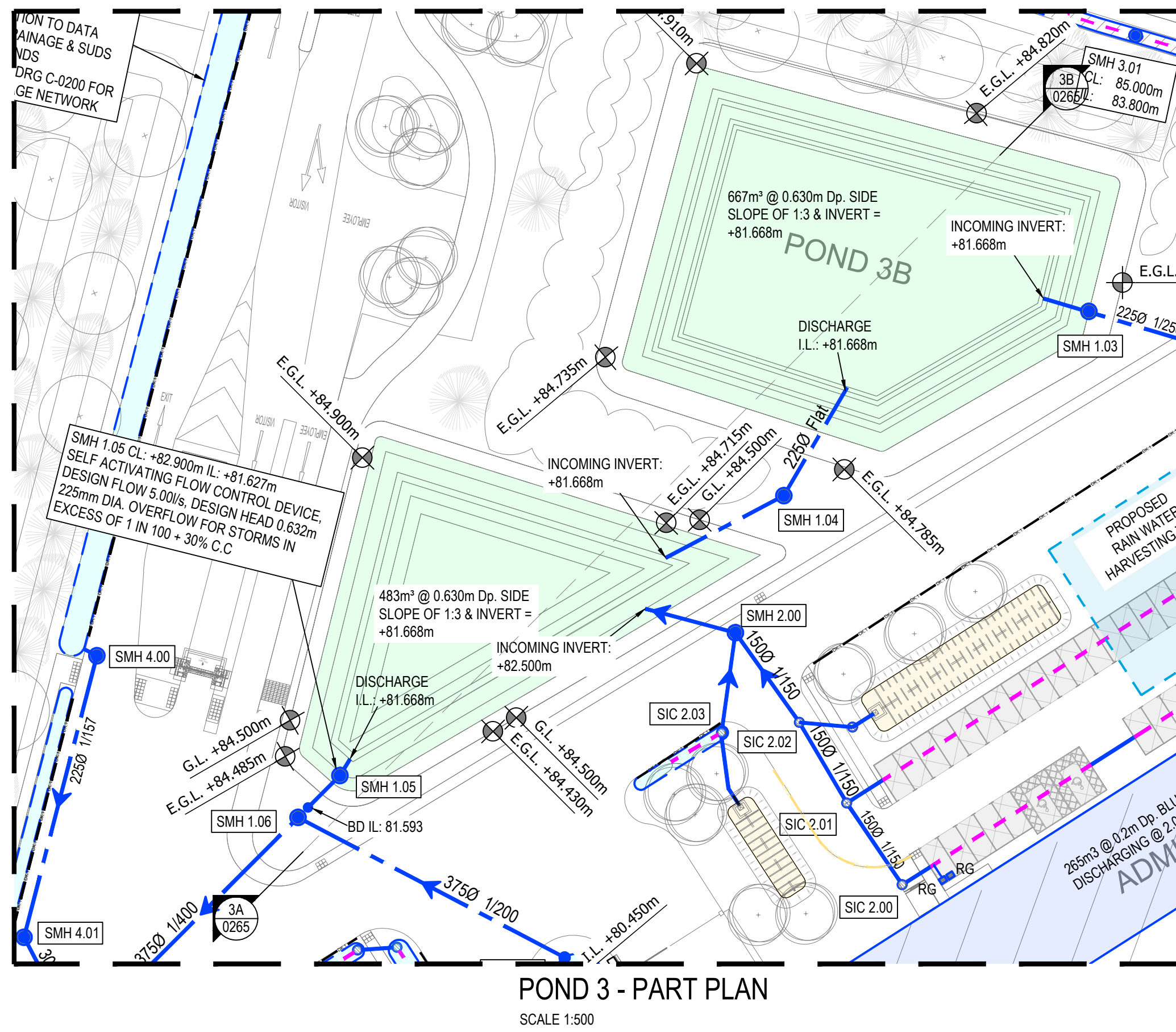
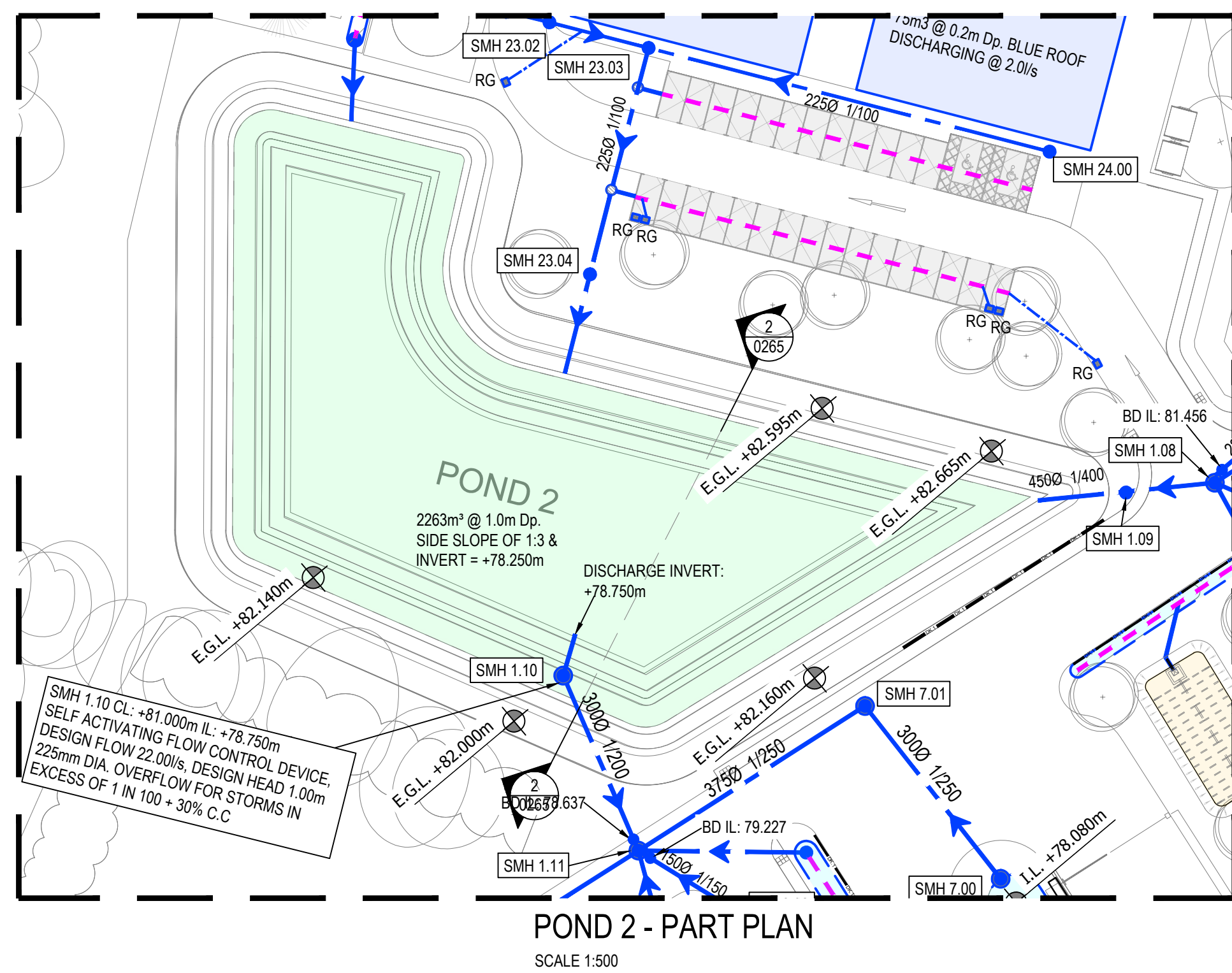

KEY PLAN
TRUE NORTH

PLANNING

PROJECT: HERBATA DATA CENTRE CAMPUS
PROJECT: NAAS, CO. KILDARE

DATE: 28/04/2023
SCALE: As Shown @ A0

RKD
R. K. DONNACHADH O'BRIEN & ASSOCIATES CONSULTING ENGINEERS

BSM
B. S. MURPHY & ASSOCIATES CONSULTING ENGINEERS

Rev.	Date	Description
P08	28/04/2024	ISSUED FOR PLANNING
P07	03/11/2023	ISSUED FOR PLANNING
P06	07/09/2023	ISSUED FOR PLANNING
P05	06/08/2023	ISSUED FOR PLANNING
P04	12/07/2023	ISSUED FOR INFORMATION
P03	10/07/2023	PROGRESS ISSUE
P02	30/06/2023	PROGRESS ISSUE
P01	06/06/2023	PROGRESS ISSUE